

NEW-FLOW

**ISO 9001
REGISTERED**

NEW-FLOW

Instruction Manual

PLASTIC RELIEF VALVES

RV-10



NEW-FLOW TECHNOLOGIES, INC.

No.9 Lane 133, Xing-Hua St., Chien Chen Dist., Kaohsiung 806, Taiwan

TEL: 886-7-8135500 FAX: 886-7-8225588 / 8159758

Email: info@new-flow.com www.new-flow.com

INSTALLATION

Technical Data

Low lift relief valves

Material: Body-P.V.C, P.P, PVDF;
Diaphragm membrane-Viton
CV: 0.7

Inlet pressure: maximum 1.4Mpa (203psi)

Adjustable range: 0.03~1.0 Mpa (5~150psi)

Working temp.: 60°C

Working fluid: Water corrosive liquid

Panel mounting available

Range Table

Code	Range
5R	5~25 PSI
26R	26~80 PSI
81R	81~150 PSI

Dimensions

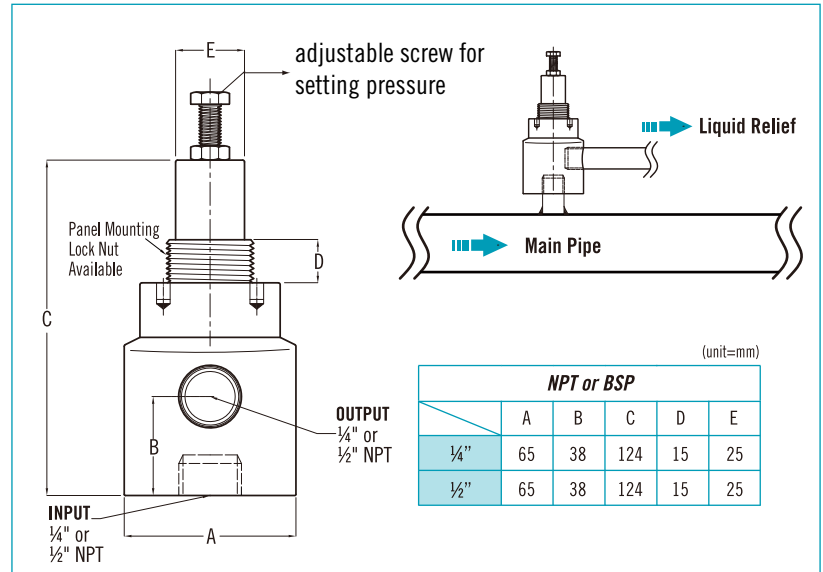

decrease ↻ increase relief setting

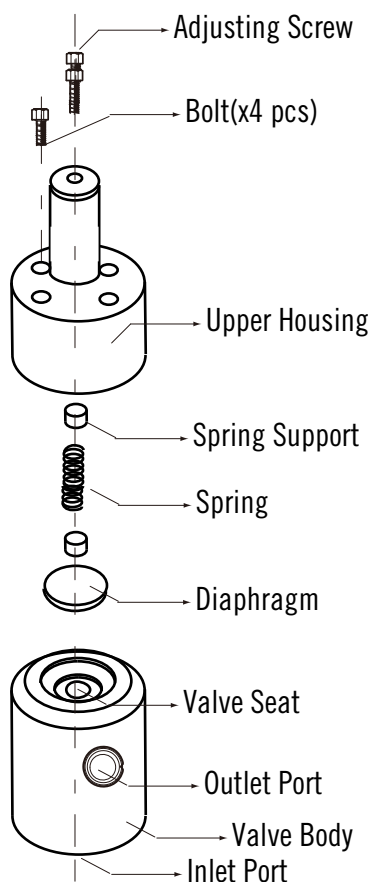

Installation Instruction

1. The Series RV-10 relief valve was designed to keep safe for tank, piping and pump when process liquid flow over pressure in these system.
2. Its function was designed as the pressure is reached the set point, valve will open slowly, when the pressure drops, valve seat will close slowly. Meanwhile the pressure lower than set pressure.
3. Don't attach this valve to metal thread to avoid plastic thread damage. To be avoid valve broken.
4. Don't use much force to tight bolt and to tight inlet or outlet threads.
5. Please clean inner face of pipe of inlet and outlet