

MAGNETIC LEVEL SWITCH

MWS TYPE



Approvals:

 TD0400TJ
 工電(2016)第00114號
 (ITRI)2017第07-00105號
 Switches with UL & CSA Recognized and File No. E41515.

Technical Data

Case Housing Material: Aluminum alloy or SS316 available
Protection Class: (Taiwan Explosion Proof Certification):
 Ex d IIB + H₂ T6 Gb
Micro Switch: SPDT x 1; SPDT x 2 (one setting point)
Rating: 3A/250VAC, 5A/125VAC, 4A/30VDC
Extension Wire Connection: Female 1/2", 3/4"NPT, PF available

Dimensions

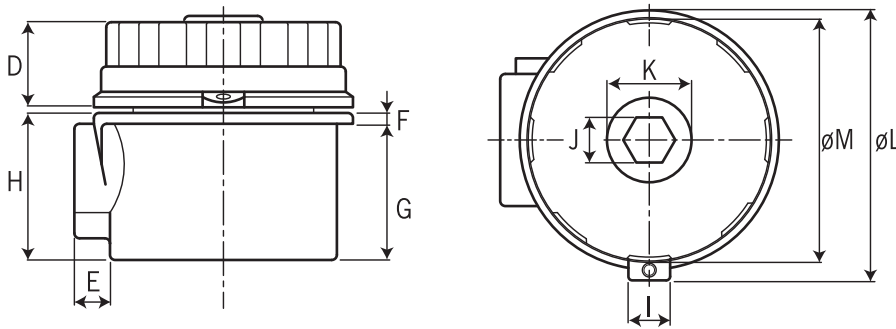

| Type | Dimensions | | | | | | | | | |
|------|------------|------|-----|------|----|------|------|------|-------|------|
| | D | E | F | G | H | I | J | K | ØL | ØM |
| MWS | 33 | 13.8 | 4.2 | 52.8 | 57 | 13.5 | 17.5 | 32.8 | 102.8 | 94.5 |

unit:mm

Wire Drawing

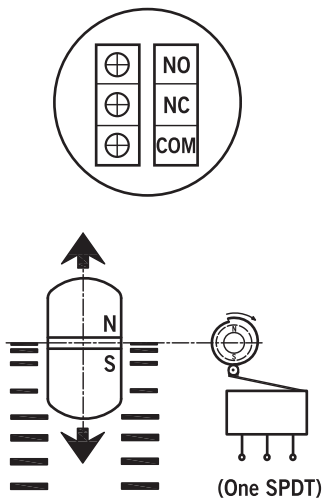

(Two SPDT)

| | |
|-----|---|
| NC | 6 |
| NO | 5 |
| COM | 4 |
| NC | 3 |
| NO | 2 |
| COM | 1 |

Option: 2 SPDT switch on request

Ordering Information

| MWS | Code | Case Material |
|-----|------|--|
| ↓ | A | Aluminum alloy |
| | B | SS316 |
| ↓ | Code | Switch Function- Micro Switch |
| | 1 | One Switch (SPDT x 1) |
| ↓ | 2 | Two Switches (SPDT x 2) |
| | Code | Conduit Size |
| ↓ | (1) | 1/2"NPT(F) |
| | (2) | 3/4"NPT(F) |
| ↓ | (3) | 1/2"PF(F) |
| | (4) | 3/4"PF(F) |
| ↓ | (5) | Option |
| | Code | Explosion Proof Type / Housing Material |
| ↓ | B | (Taiwan Explosion Proof Certification) / Aluminum alloy Ex d IIB + H ₂ T6 Gb |
| | B1 | (Taiwan Explosion Proof Certification) / SS316 Ex d IIB + H ₂ T6 Gb |
| MWS | | Complete Ordering Code |