

PADDLE FLOW SWITCH FOR LIQUIDS

FS25R – WEATHER PROOF FS25X – EXPLOSION PROOF

Easy installation into existing pipe
 For a wide range of pipe size from diameter 25 to 200
 Reed switch provide a SPST or SPDT contact function
 Max. pressure rating 1500 psi (st. steel)

Technical Data

Service: For "Non-Corrosive" liquid fluid available
 (★Please see the notice of "Reminder before ordering".)
Operation Temperature: -30~+120°C
Reed Switch: SPST: 250VAC, 100VDC, 10VA (max.) (Flow ON);
 SPDT: 150VAC/DC, 20VA (max.)
Carrying Current: 1A (max.)
Wire Conduit: 1/2" NPTF, 3/4" NPTF, and option available
Protection Class: FS25R: Weather Proof type / FS25X: Explosion Proof type
Material: Housing– Aluminum alloy (SS316 available for FS25X);
 Body– SS316+Teflon; Plate– Stainless Steel 301
Optional: other materials available upon request

Flow Rate Table

– For Standard Type:

Pipe Size	Flow Rates Required to Actuate, Deactuate (m³/h) Water at 25°C		Process Connection NPT
	Actuate (ON)	Deactuate (OFF)	
1"	1.4 m³/h	1.05 m³/h	1"
1¼"	1.45 m³/h	1.1 m³/h	1"
1½"	1.5-2 m³/h	0.9-1.5 m³/h	1"
2"	3-4 m³/h	2-4 m³/h	1"
2½"	4-5 m³/h	3-4 m³/h	1"
3"	6-7 m³/h	5-6 m³/h	1"
4"	10-14 m³/h	5-10 m³/h	1"
6"	20-30 m³/h	12-17 m³/h	1"
8"	30-35 m³/h	25-30 m³/h	1"

– For add Tee Type:

Tee Fitting	Flow Direction	Flow Rates Required to Actuate, Deactuate (L/H) Water at 25°C	
		Actuate (ON)	Deactuate (OFF)
1"NPT	Vertical	583-585 L/H	523-527 L/H
	Horizontal	398-399 L/H	283-284 L/H

NOTE.

The Flow Rate Table is only for reference.
 Please consult with manufacturer for the accurate flow rate if necessary.

Dimensions

FS25R

Head Type: HN/ Aluminum alloy
 Protection: IP68

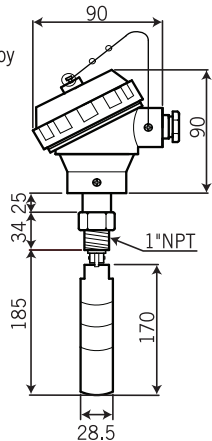

FS25X- XDS/XDA

Head Type: XDS: SS316; XDA: Aluminum alloy
ATEX Approvals: II 2G D
 Ex db IIC Gb
 Ex tb IIIC Db

FM Approvals: XP/II/1/ABCD/T6; DIP/II, III/1/EF/G/T6;
 Type 4X Explosion proof for Class I, Division 1, Groups A, B, C and D; and dust-ignitionproof for Class II, III Division 1, Groups E, F and G, hazardous (classified) locations; indoor/outdoor (NEMA Type 4X).

FS25X- ES/EA

Head Type: ES: SS316; EA: Aluminum alloy
Explosion Proof: (Taiwan Explosion Proof Certification)
 Ex d IIB + H2 T6 Gb

XDS/XDA Head

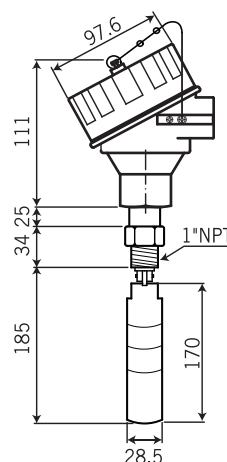

ES/EA Head

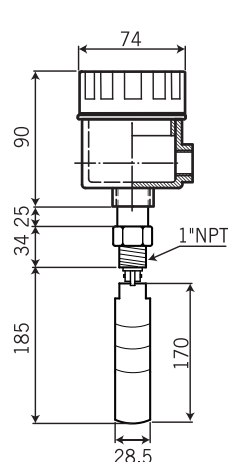

FS25R



FS25X



L Specify by user

Extension Arm Type



Add Tee For Emergency Shower System

Approvals:



Switches with Intertek Test Report, refer to UL508 Standard.

TD0400TJ
 工電(2016)第00428號
 (ITRI)2017第07-00104號

Dimensions

Extension Arm Type

Please specify length of "L" as request.

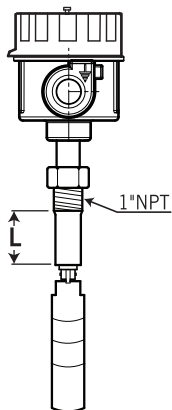

With Tee, for Emergency Shower System

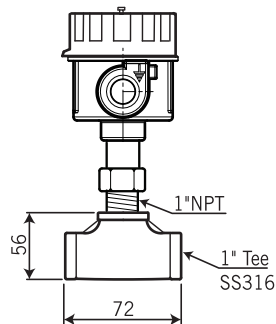

Ordering Information

FS25	Code	Type			
	R	Weather Proof	X	Explosion Proof	
	Code	Head Housing Type			
		(1) HN (only for FS25R) (2) XDS (3) XDA (4) ES (5) EA (0) option			
	Code	Process Connection			
	A	1"NPT(M), standard			
	B	Extension Arm Type (Length L: Specify by user)			
	C1	With SS316 Tee, 1"NPT(F)			
	C2	With SS316 Tee, 1"NPT(F) assemble with reducing adapter 3/4"NPT(F)			
	O	Option			
	Code	Conduit Size – Female			
		(1) 1/2"NPT, standard (2) 3/4"NPT (0) Option			
	Code	Reed Switch Rating			
	SPST	250VAC, 100VDC, 10VA (max.) (Flow ON)			
	SPDT	150VAC/DC, 20VA (max.)			
	Code	Explosion Proof Type / Head Housing Type			
	N	For Weather proof type, FS-25R			
	B	Taiwan Explosion Proof Certification / ES & EA: Ex d IIB + H2 T6 Gb			
	S	Certificate on Housing Only / XDS & XDA: II 2G D Ex db IIC Gb Ex tb IIIC Db			
FS25					Complete Ordering Code

Reminder before ordering:

In general, We DON't recommend using FS25 for the seawater application!
But, if it is necessary, please let us know before placing an order, we can customize the special magnet with lining to match up!